

£850 PCM

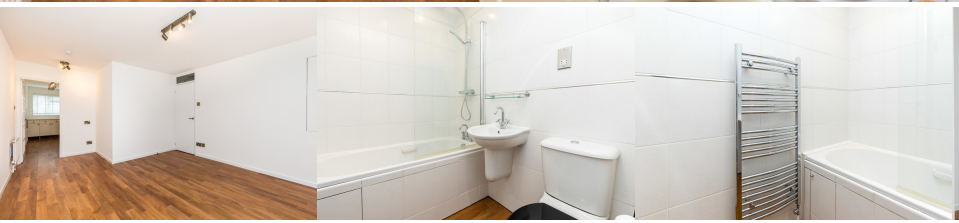

**£850 PCM**

## Features

- Spacious Accommodation
- Fully Redecorated
- New Wooden Flooring Throughout
- Allocated Parking
- Fitted Mirrored Wardrobe
- Gas Central Heating

## Description

Sussex Letting Centre are pleased to offer a spacious, very well presented, 1 bedroom first floor flat situated in a quiet sought after residential area, fully redecorated and new wooden floors throughout.

The property comprises of its own private entrance, stairs leading to the hallway, good size living room, galley style kitchen with fridge freezer & washing machine, modern bathroom with shower over bath, double bedroom with fitted mirrored wardrobes, allocated parking space. The property also benefits from gas central heating, double glazing.

UNFURNISHED. AVAILABLE NOW.

EPC Rating C. Council tax band B. Small pets considered.

£850 PCM



## Floor Plan

### First Floor

Approx. 44.1 sq. metres (474.7 sq. feet)

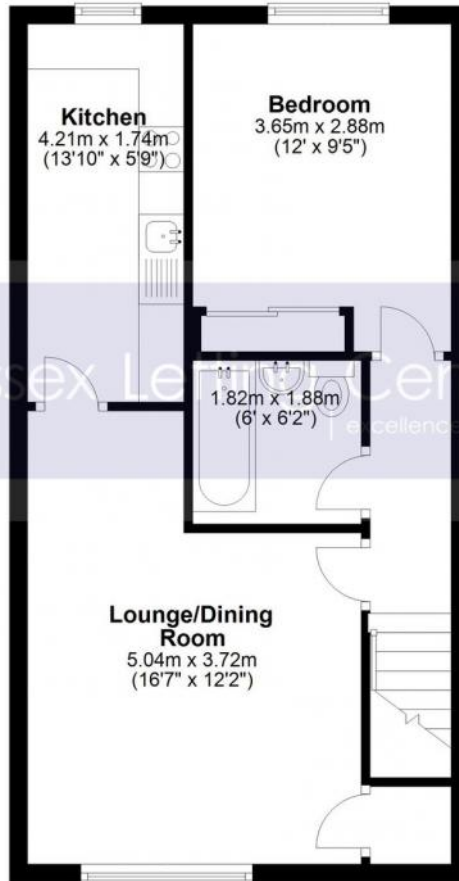

Sussex Letting Centre

excellence is our minimum standard