

£1,350 PCM

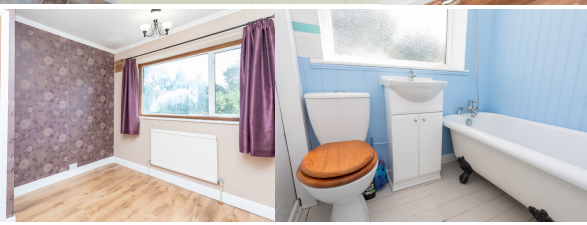

£1,350 PCM

Features

- Ideal catchment area for The Gattons School
- Large Rear garden with shed/Green house/Raised beds
- Pets considered
- Driveway
- Garage
- Council tax band C
- EPC rating D

Description

Sussex Letting Centre are pleased to offer a two bedroom semi detached house located in close proximity to Burgess Hill Town Centre and an ideal catchment area for The Gattons School.

In brief, the property comprises of entrance hall, good size lounge/diner leading to a sun room extension, kitchen with appliances, utility/garage storage room, main double bedroom with built in wardrobe, second smaller double bedroom with built in cupboard, bathroom with shower over a free-standing bath, large garden leading to a 2nd garden area with shed, green house and raised beds, garage & driveway for two cars.

PETS CONSIDERED.

Unfurnished. Available from 8th June

Mid Sussex District Council tax band C

EPC Rating D

Based on the advertised rent a holding deposit of £311.53 is required to reserve this property. Min Term 12 months.
Total deposit payable is £1557.00

£1,350 PCM

2  1  2 

Floor Plan

Ground Floor

Approx. 42.8 sq. metres (460.8 sq. feet)

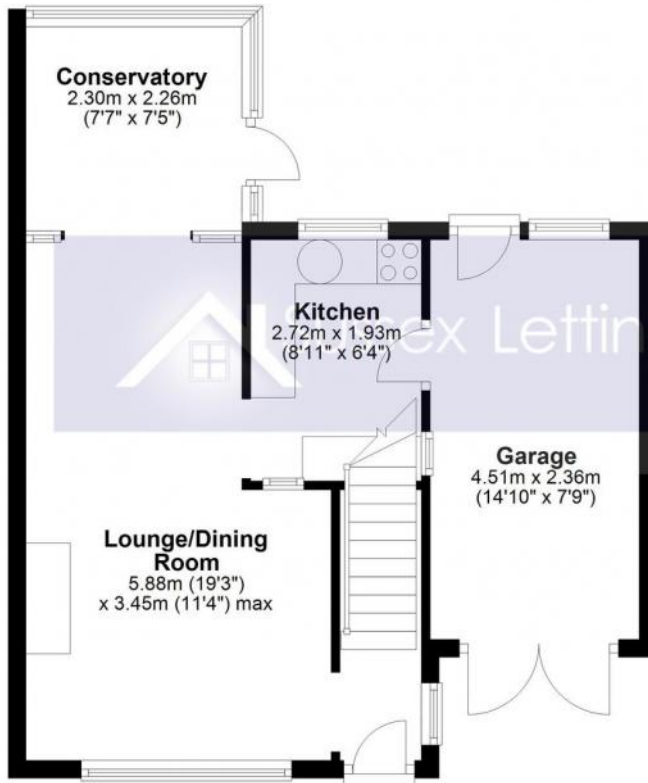

First Floor

Approx. 27.3 sq. metres (293.8 sq. feet)

